



PRISM HARDSCAPES
Outdoor Living Products



We believe in spaces that are designed for living, for making memories, for enjoying life.

Prism Hardscapes is a progressive company that focuses on outdoor living products. We are committed to current architectural trends, visionary designs, coupled with handcrafted processes, allowing for a beautiful and affordable outdoor living space. We intend to be on the forefront of exceptional product design, quality, and value.

Backed by 100 years of experience, Natco Home is a family owned business that was established in 1917. Natco Home is one of the largest and most respected companies in the Home Textiles, and outdoor living products industry with wholly owned manufacturing facilities in Georgia, Maine, California and Toronto, as well as several joint ventures in China, Poland, Egypt, Turkey and Mexico. Natco Home delivers today's hottest home fashion colors and designs at surprisingly affordable price points.

2020

04	Tavola 1	16	Moderno 6
04	Tavola 2	18	Pentola 1
05	Tavola 3	18	Pentola 2
05	Tavola 4	19	Pentola 3
06	Tavola 5	19	Scatola
06	Tavola 6	21	Pebble
07	Tavola 7	21	Rotondo
07	Tavola 42	22	Lombard
10	Portos 68	22	Embarcadero
10	Portos 58	25	Propane Enclosures
12	Moderno 1	26	Lombard (Pedestal)
12	Moderno 2	26	Embarcadero (Pedestal)
15	Moderno 3	28	Burner Assembly
15	Moderno 4	30	Falò (Wood Burning)
16	Moderno 5	32	Color Options & Rock Media



CRAFTSMANSHIP

From concept, to finished product, the craftsman element is present in every aspect of our process. Each of our products have been hand-crafted using our custom patina finishing process, guaranteeing a one-of-a-kind creation with subtle variation.



Tavola 1



SPECIFICATIONS

Width	38"
Length	56"
Height	16"
Surface	11"
Burner Size	24" / 65,000 BTU
Weight	360 lbs.
Fuel Source	LP or NG
Ignition	Key Valve
Materials	Glass fiber reinforced cement



Tavola 2



SPECIFICATIONS

Width	36"
Length	36"
Height	16"
Surface	8 1/4"
Burner Size	15" / 65,000 BTU
Weight	240 lbs.
Fuel Source	LP or NG
Ignition	Key Valve
Materials	Glass fiber reinforced cement

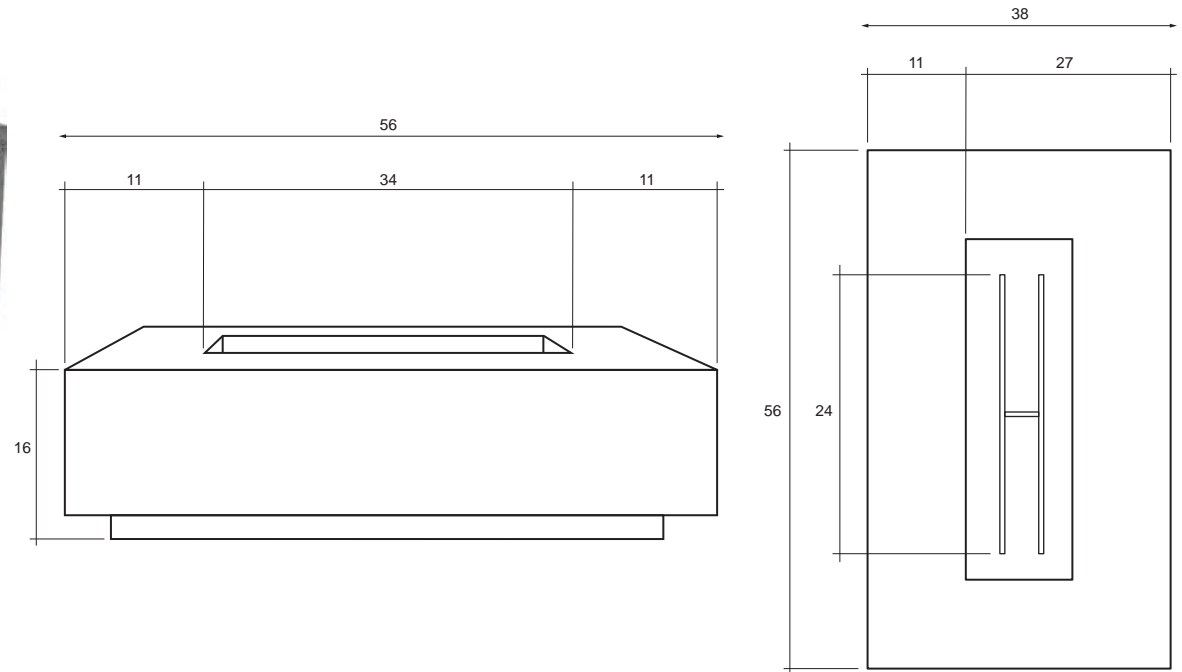

Tavola 3



SPECIFICATIONS

Width	48"
Length	48"
Height	16"
Surface	12"
Burner Size	18" / 65,000 BTU
Weight	450 lbs.
Fuel Source	LP or NG
Ignition	Key Valve
Materials	Glass fiber reinforced cement

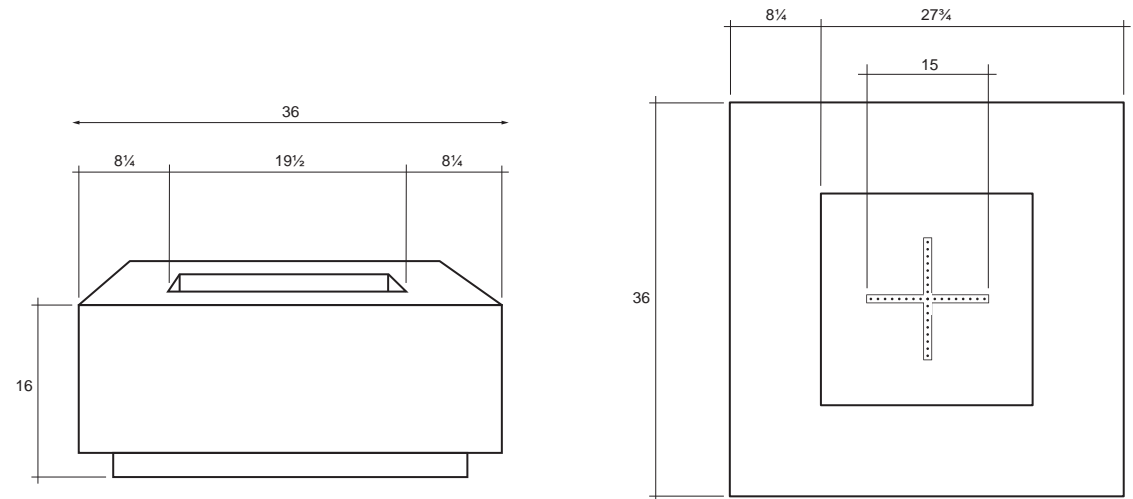

Tavola 4



SPECIFICATIONS

Width	38"
Length	66"
Height	16"
Surface	16" / 11"
Burner Size	24" / 65,000 BTU
Weight	500 lbs.
Fuel Source	LP or NG
Ignition	Key Valve
Materials	Glass fiber reinforced cement

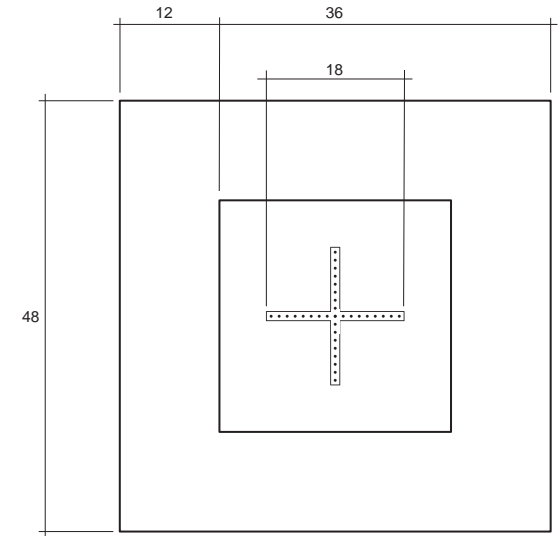
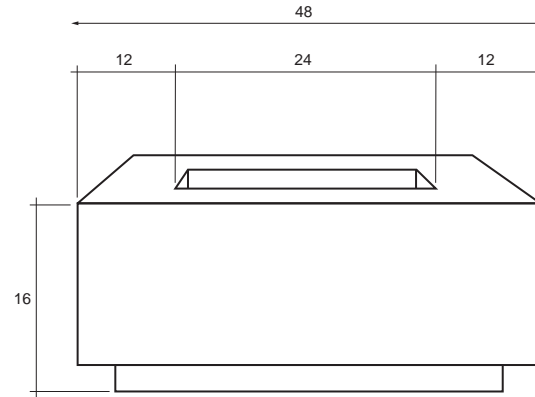

Tavola 5



SPECIFICATIONS

Width	38"
Length	80"
Height	16"
Surface	11" / 33¾"
Burner Size	24" / 65,000 BTU
Weight	650 lbs.
Fuel Source	LP or NG
Ignition	Key Valve
Materials	Glass fiber reinforced cement

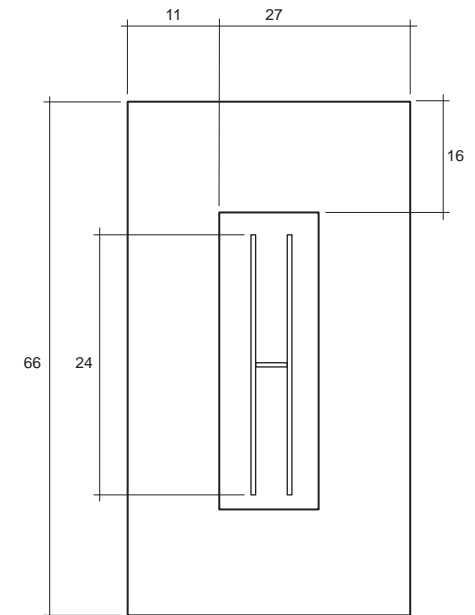
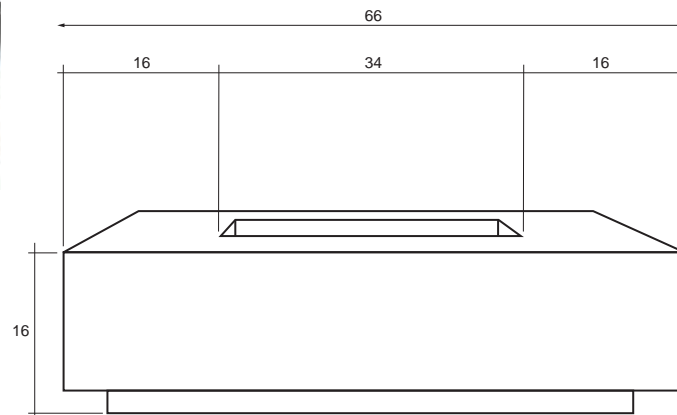

Tavola 6



SPECIFICATIONS

Width	38"
Length	90"
Height	16"
Surface	11"
Burner Size	56" / 90,000 BTU
Weight	650 lbs.
Fuel Source	LP or NG
Ignition	Key Valve
Materials	Glass fiber reinforced cement

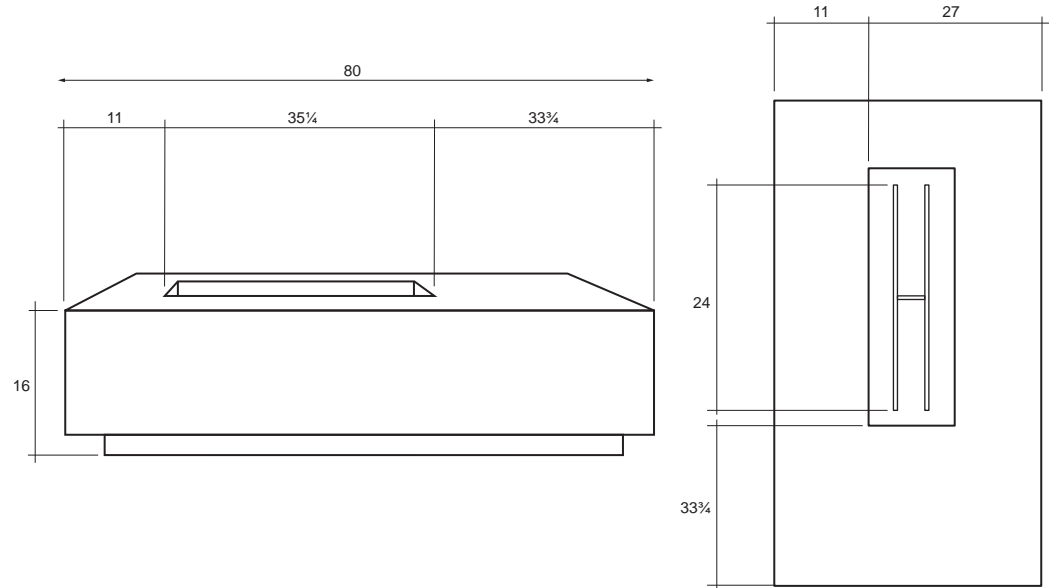

Tavola 7



SPECIFICATIONS

Width	50"
Length	60"
Height	16"
Surface	16"
Burner Size	24" / 65,000 BTU
Weight	500 lbs.
Fuel Source	LP or NG
Ignition	Key Valve
Materials	Glass fiber reinforced cement

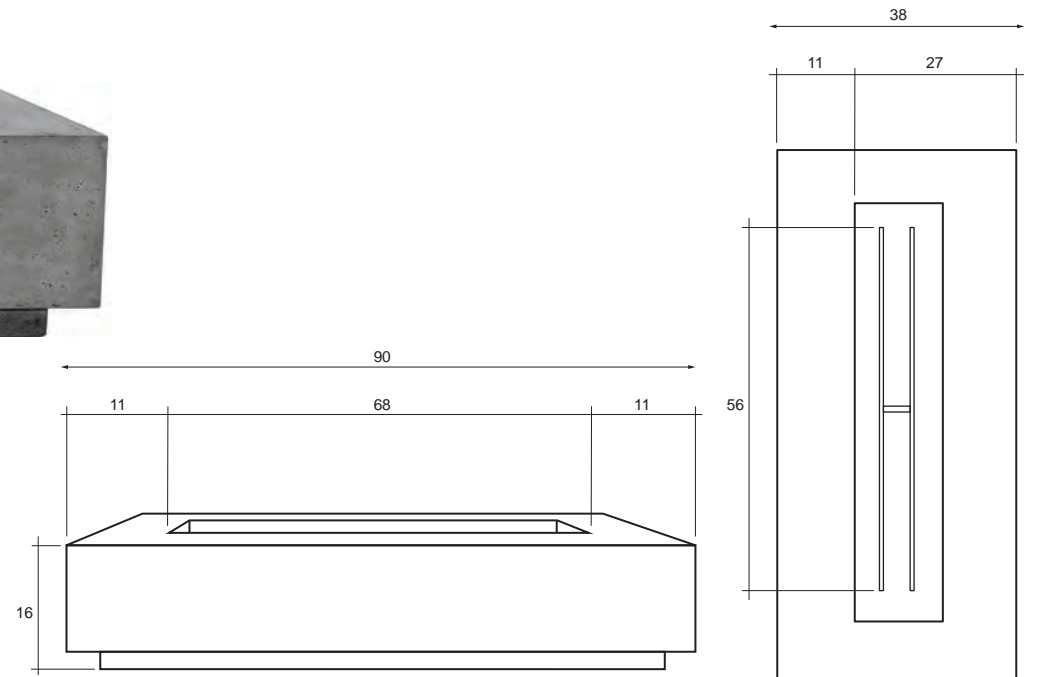

Tavola 42



SPECIFICATIONS

Width	42"
Length	42"
Height	16"
Surface	8 1/4"
Burner Size	15" / 65,000 BTU
Weight	360 lbs.
Fuel Source	LP or NG
Ignition	Key Valve
Materials	Glass fiber reinforced cement

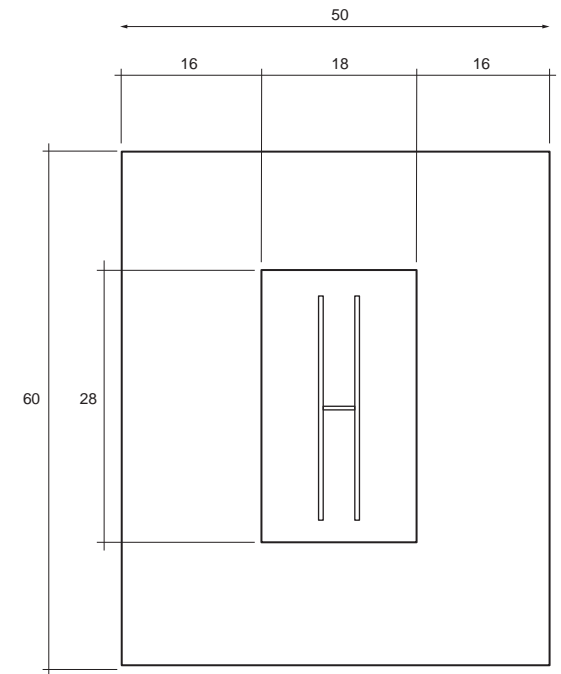
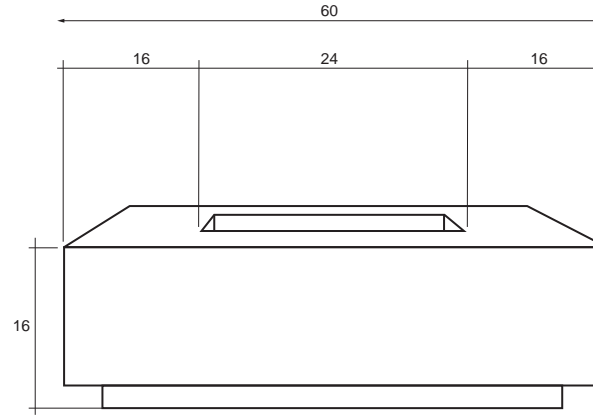
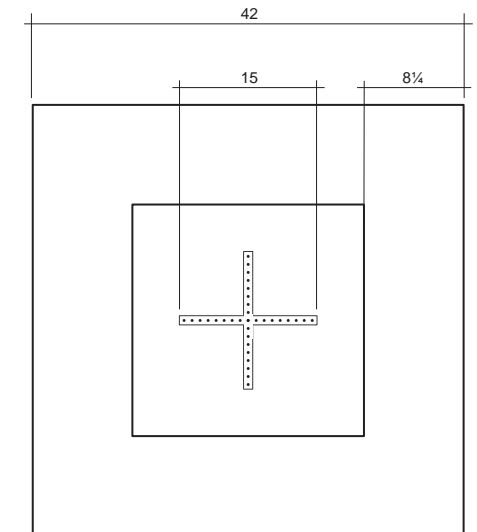
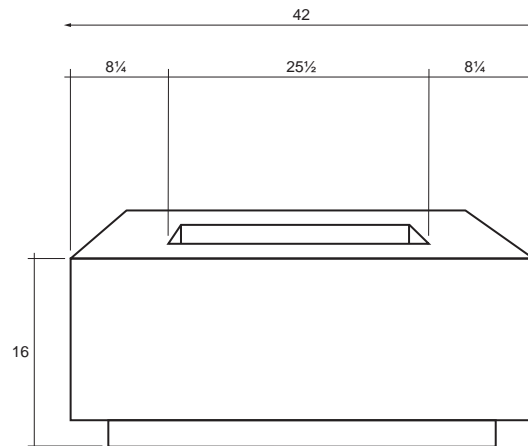





Portos 68 (Enclosed Propane Unit)



SPECIFICATIONS	
Width	38"
Length	68"
Height	22"
Surface	17" / 11"
Burner Size	24" / 65,000 BTU
Weight	550 lbs.
Fuel Source	Enclosed Propane Unit
Ignition	Key Valve
Materials	Glass fiber reinforced cement

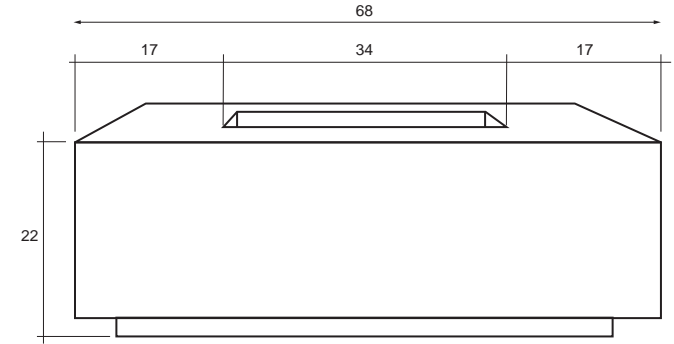

Portos 58 (Enclosed Propane Unit)



SPECIFICATIONS	
Width	38"
Length	58"
Height	22"
Surface	12" / 11"
Burner Size	24" / 65,000 BTU
Weight	450 lbs.
Fuel Source	Enclosed Propane Unit
Ignition	Key Valve
Materials	Glass fiber reinforced cement

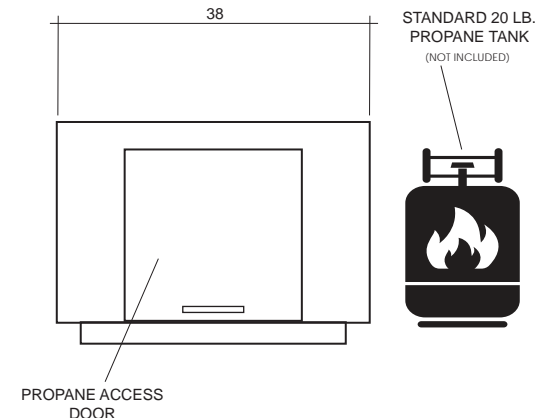
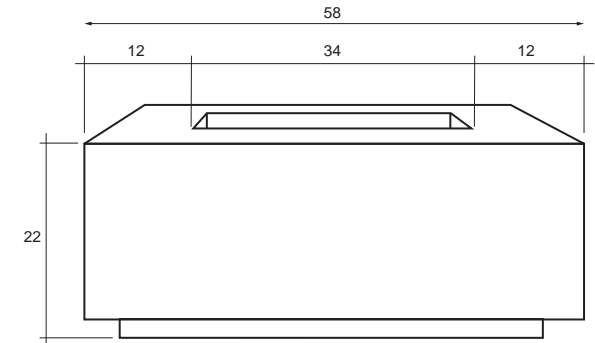



Moderno 1



SPECIFICATIONS

Diameter	39"
Bottom Diameter	16"
Height	18"
Burner Size	15" / 65,000 BTU
Weight	210 lbs.
Fuel Source	LP or NG
Ignition	Key Valve
Materials	Glass fiber reinforced cement

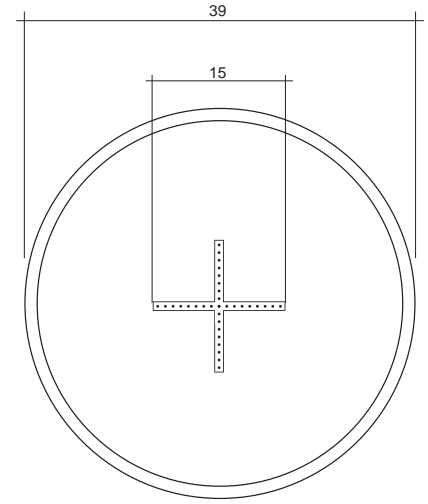
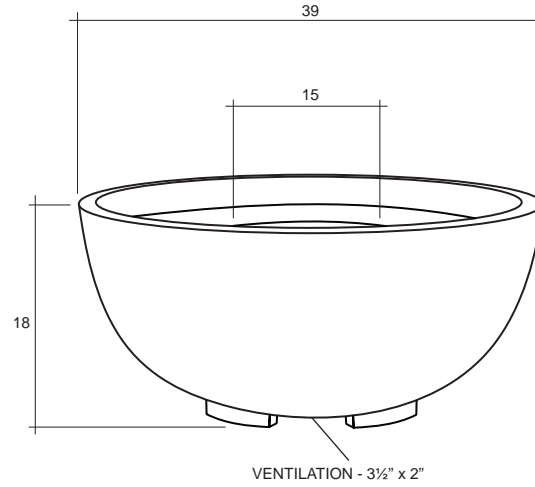

Moderno 2



SPECIFICATIONS

Diameter	29"
Bottom Diameter	14"
Height	12"
Burner Size	15" / 65,000 BTU
Weight	90 lbs.
Fuel Source	LP or NG
Ignition	Key Valve
Materials	Glass fiber reinforced cement

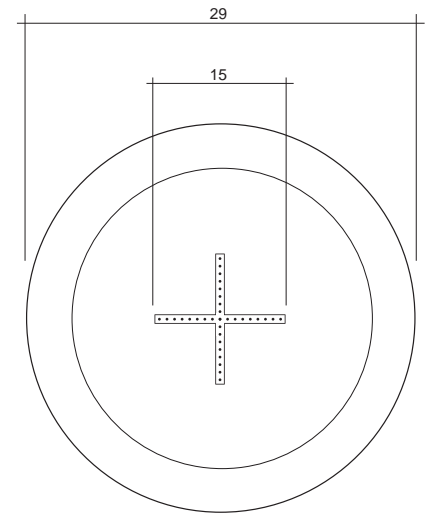
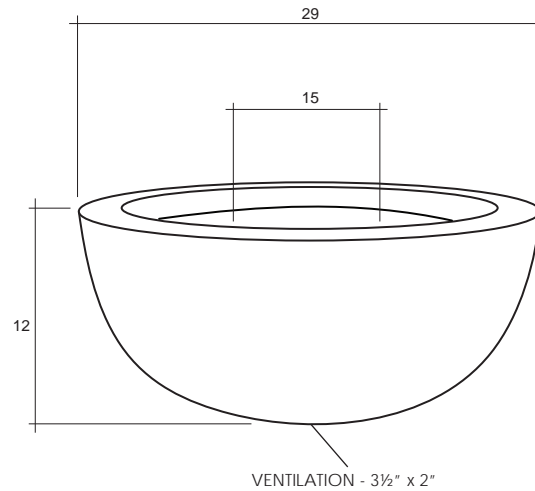





Moderno 3



SPECIFICATIONS	
Diameter	30"
Bottom Diameter	14"
Height	18"
Burner Size	15" Diameter / 65,000 BTU
Weight	125 lbs.
Fuel Source	LP or NG
Ignition	Key Valve
Materials	Glass fiber reinforced cement

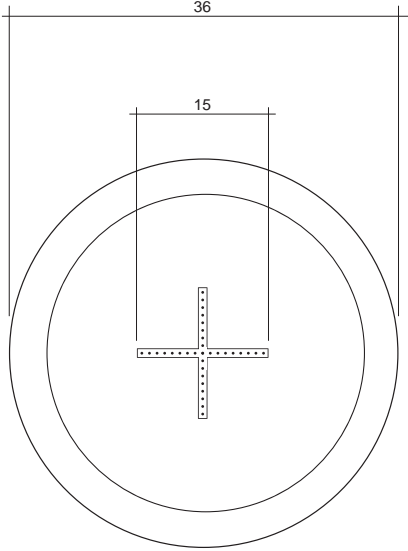
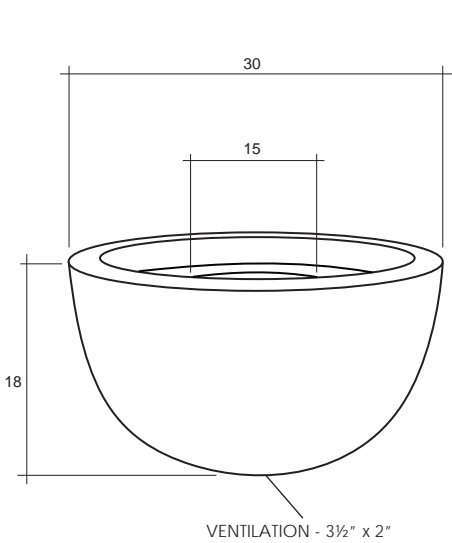

Moderno 4



SPECIFICATIONS	
Diameter	48"
Bottom Diameter	24"
Height	17"
Burner Size	18" / 65,000 BTU
Weight	400 lbs.
Fuel Source	LP or NG
Ignition	Key Valve
Materials	Glass fiber reinforced cement

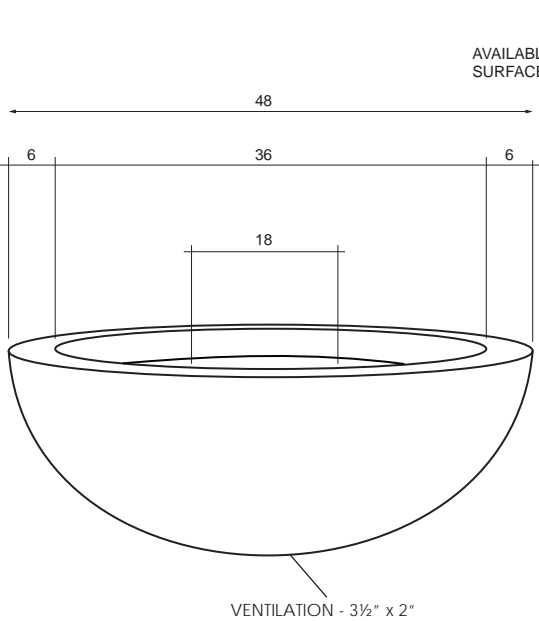

AVAILABLE WITH 4" SURFACE AREA

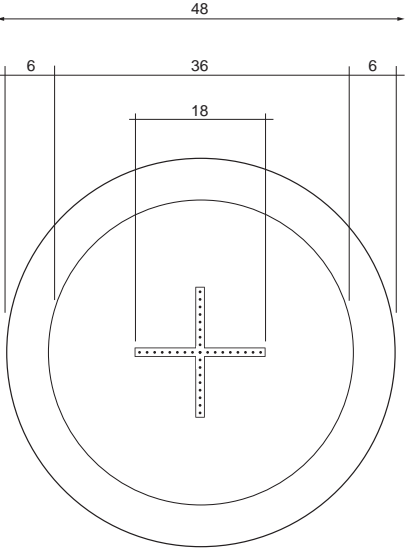

Moderno 5



SPECIFICATIONS

Diameter	36"
Height	16"
Burner Size	15" / 65,000 BTU
Weight	105 lbs.
Fuel Source	LP or NG
Ignition	Key Valve
Materials	Glass fiber reinforced cement

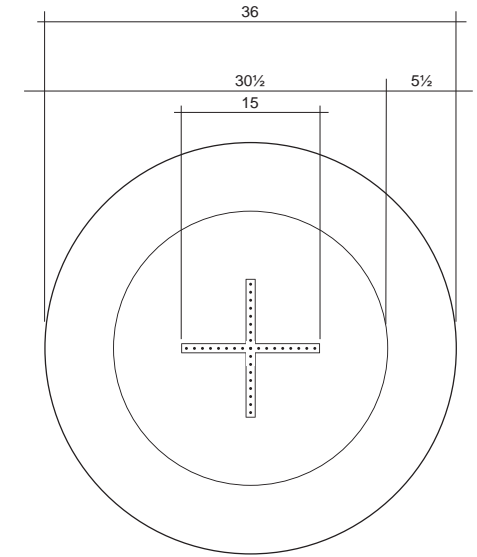
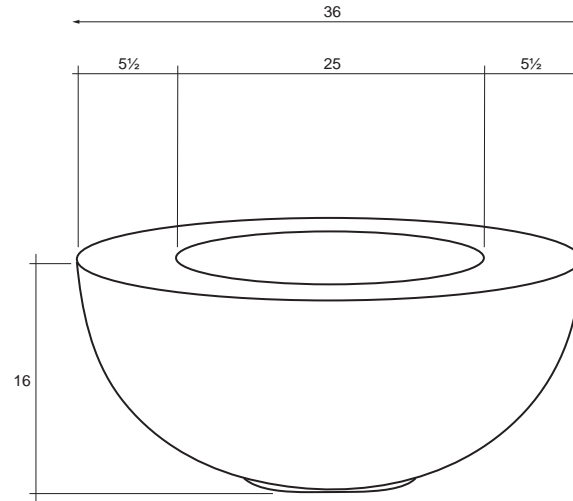

Moderno 6



SPECIFICATIONS

Diameter	39"
Height	15"
Burner Size	15" / 65,000 BTU
Weight	95 lbs.
Fuel Source	LP or NG
Ignition	Key Valve
Materials	Glass fiber reinforced cement

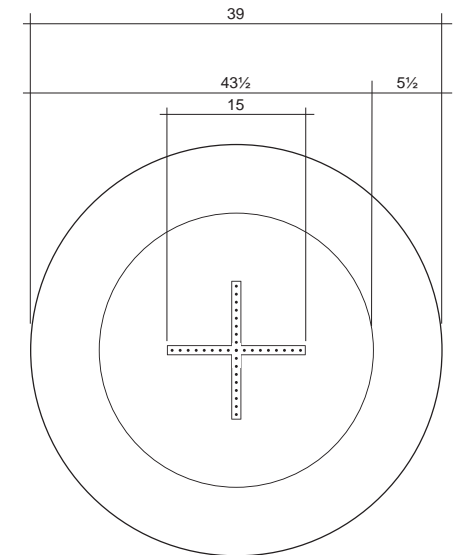
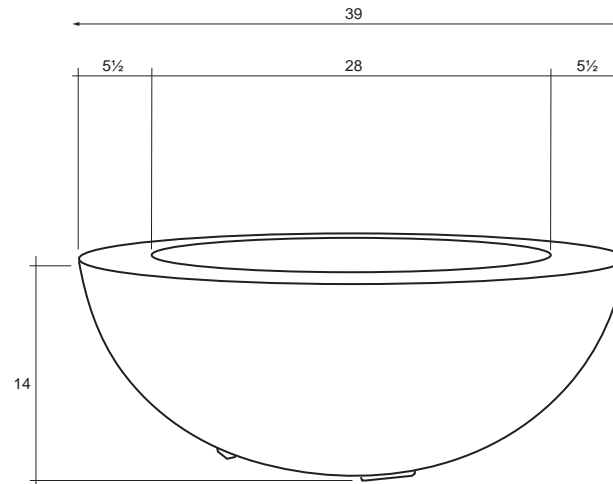



Pentola 1



SPECIFICATIONS

Diameter	24"
Height	28"
Burner Size	15" Diameter / 65,000 BTU
Weight	135 lbs.
Fuel Source	LP or NG
Ignition	Key Valve
Materials	Glass fiber reinforced cement

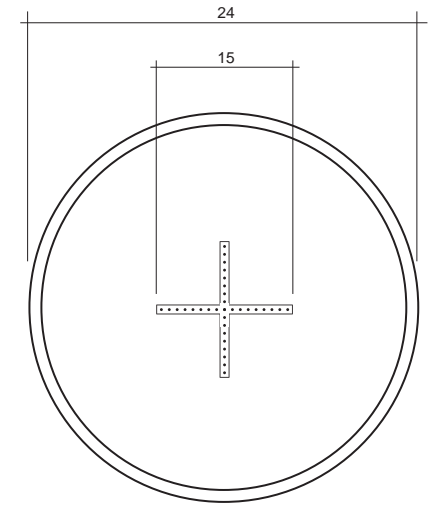
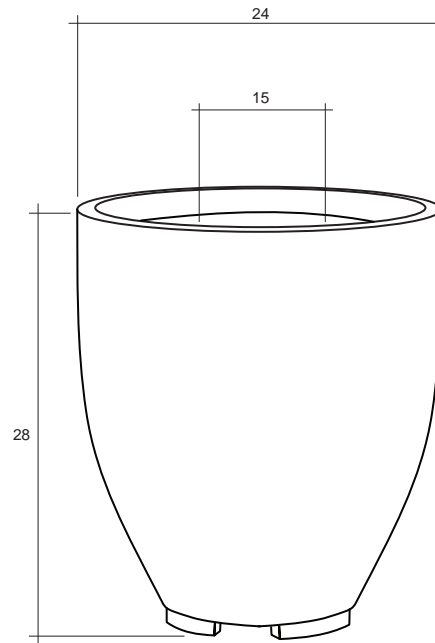

Pentola 2



SPECIFICATIONS

Diameter	24"
Height	21"
Burner Size	15" Diameter / 65,000 BTU
Weight	125 lbs.
Fuel Source	LP or NG
Ignition	Key Valve
Materials	Glass fiber reinforced cement

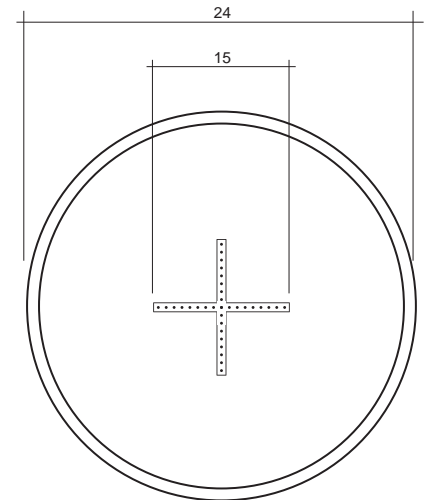
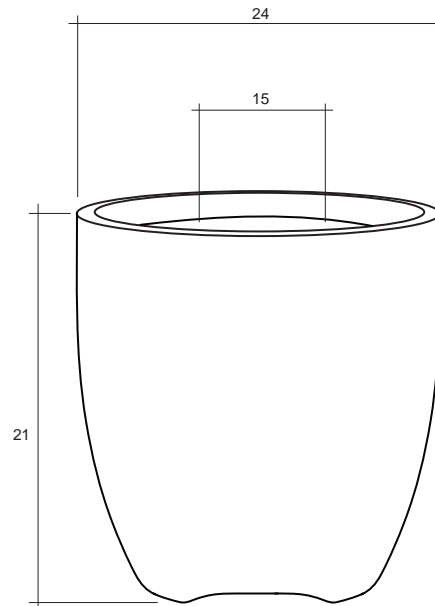

Pentola 3 (Enclosed Propane Unit)



SPECIFICATIONS

Diameter	24"
Height	26"
Burner Size	15" / 65,000 BTU
Weight	135 lbs.
Fuel Source	Enclosed Propane
Ignition	Key Valve
Materials	Glass fiber reinforced cement

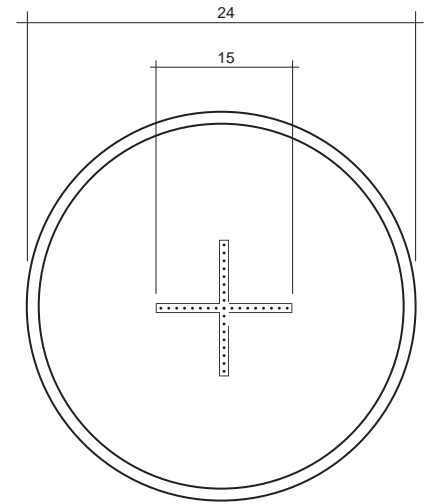
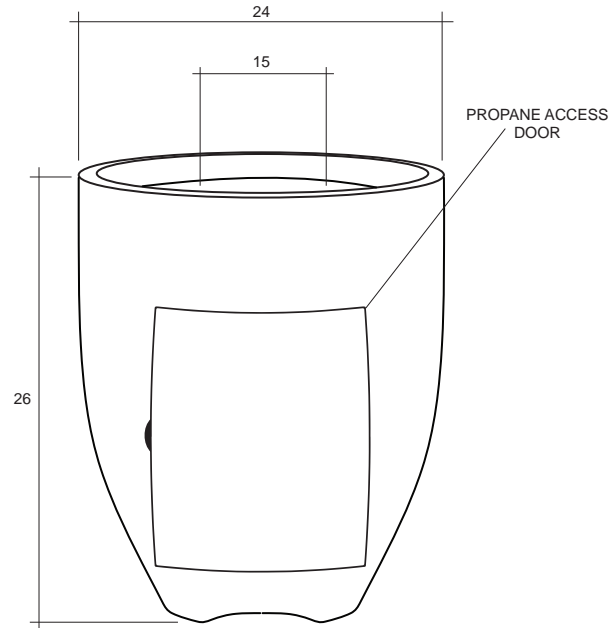

Scatola



SPECIFICATIONS

Width	20"
Height	18"
Burner Size	14" / 65,000 BTU
Weight	130 lbs.
Fuel Source	LP or NG
Ignition	Key Valve
Materials	Glass fiber reinforced cement

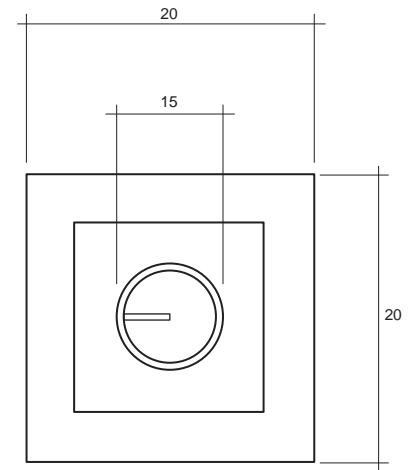
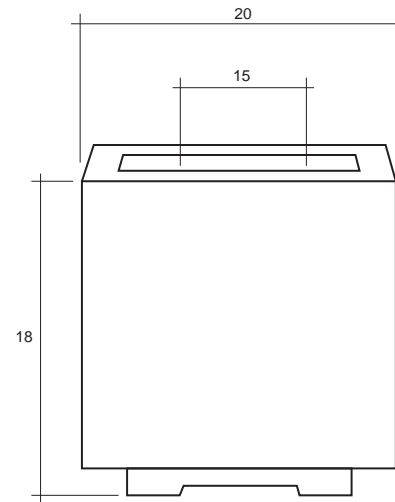



Pebble



SPECIFICATIONS	
Width	38"
Length	56"
Height	16"
Burner Size	24" / 65,000 BTU
Weight	350 lbs.
Fuel Source	LP or NG
Ignition	Key Valve
Materials	Glass fiber reinforced cement

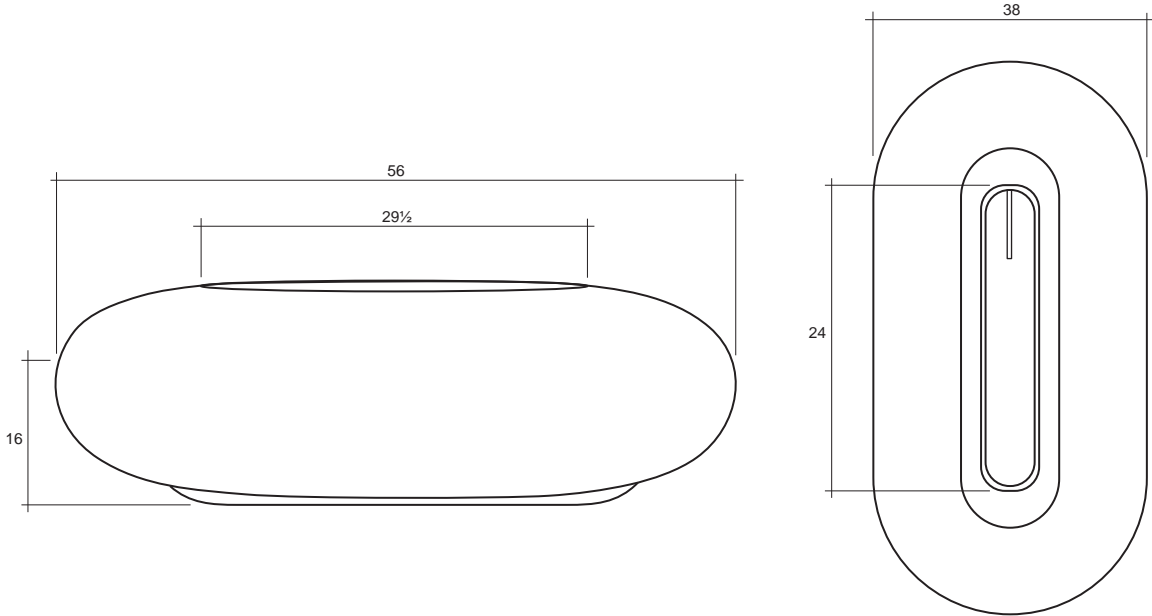

Rotondo



SPECIFICATIONS	
Diameter	48"
Height	18"
Surface	11"
Burner Size	18" / 65,000 BTU
Weight	430 lbs.
Fuel Source	LP or NG
Ignition	Key Valve
Materials	Glass fiber reinforced cement

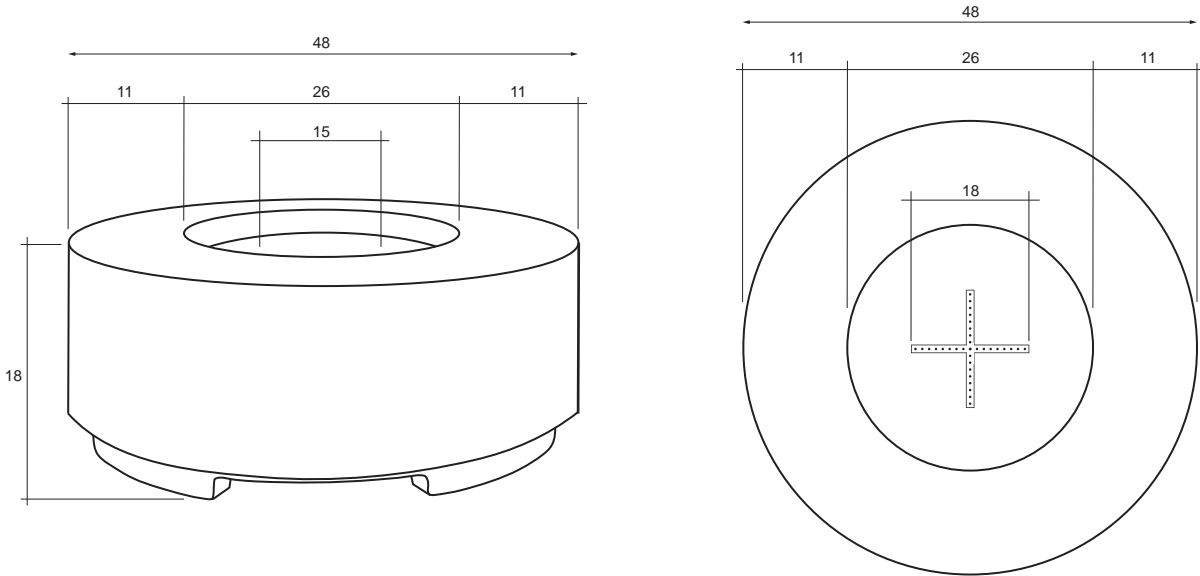

Lombard



SPECIFICATIONS

Width	40"
Height	18"
Surface	6"
Burner Size	18" / 65,000 BTU
Weight	280 lbs.
Fuel Source	LP or NG
Ignition	Key Valve
Materials	Glass fiber reinforced cement

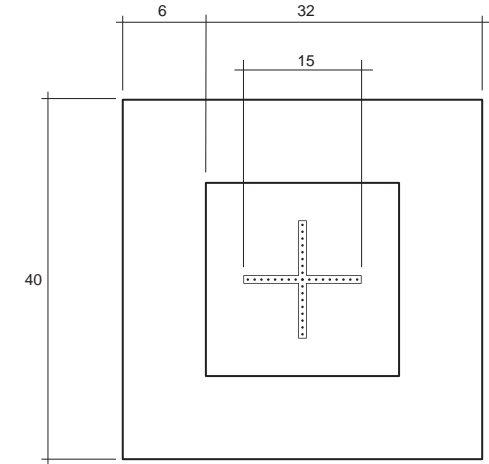
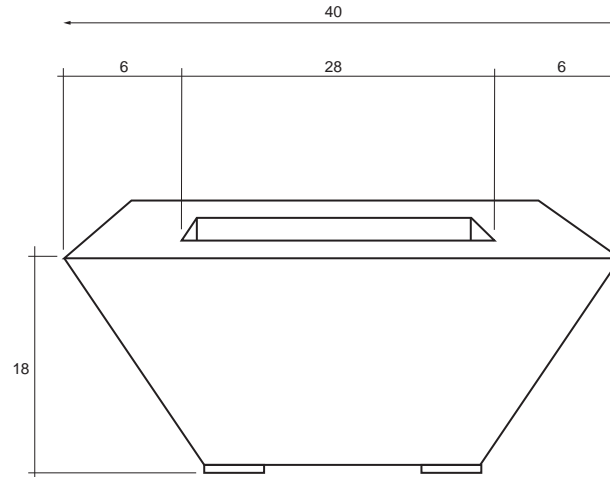

Embarcadero



SPECIFICATIONS

Diameter	48"
Height	15"
Surface	7"
Burner Size	18" / 65,000 BTU
Weight	225 lbs.
Fuel Source	LP or NG
Ignition	Key Valve
Materials	Glass fiber reinforced cement

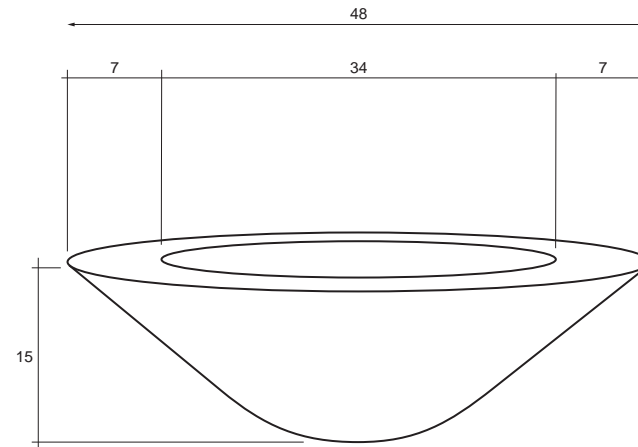

Mounting Plate Included

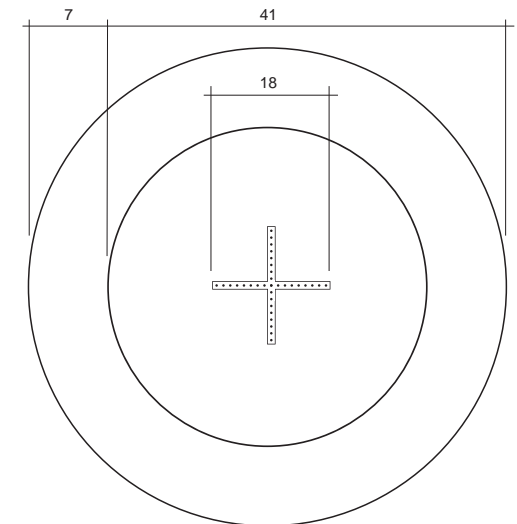





Propane Enclosures



TAV SPECIFICATIONS

Width	20"
Height	21½"
Weight	80 lbs.
Materials	Glass fiber reinforced cement

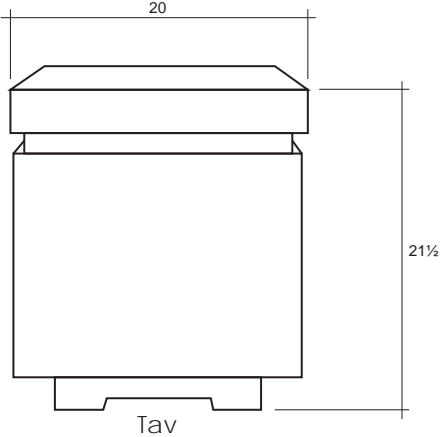

MOD SPECIFICATIONS

Diameter	20"
Height	21½"
Weight	80 lbs.
Materials	Glass fiber reinforced cement

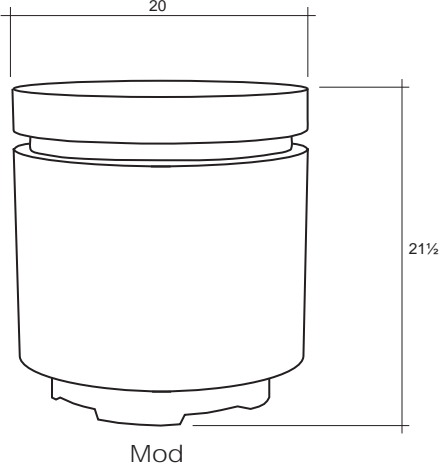

SAUSALITO SPECIFICATIONS

Width	20"
Height	21½"
Weight	80 lbs.
Materials	Glass fiber reinforced cement

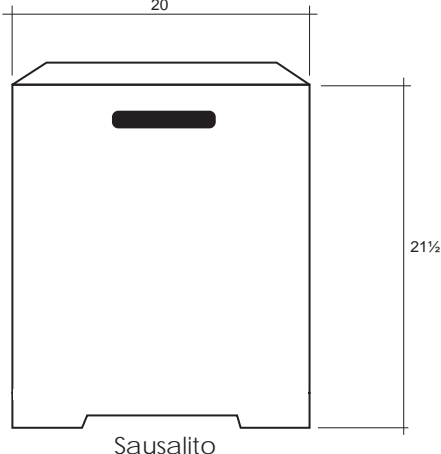

Lombard (Pedestal)



SPECIFICATIONS

Width	29"
Height	14"
Surface	3"
Burner Size	15" / 65,000 BTU
Weight	90 lbs.
Fuel Source	LP or NG
Ignition	Key Valve
Materials	Glass fiber reinforced cement

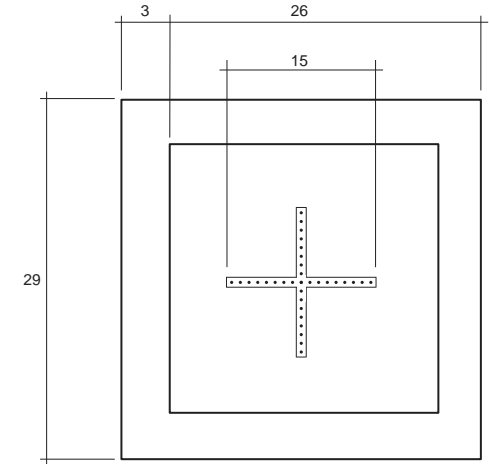
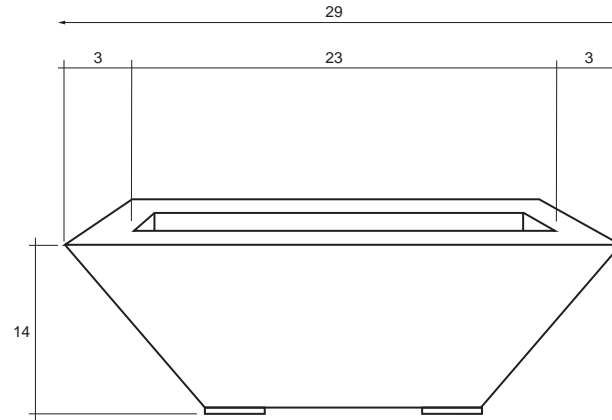

Embarcadero (Pedestal)



SPECIFICATIONS

Diameter	31"
Height	10"
Surface	2½"
Burner Size	15" / 65,000 BTU
Weight	90 lbs.
Fuel Source	LP or NG
Ignition	Key Valve
Materials	Glass fiber reinforced cement

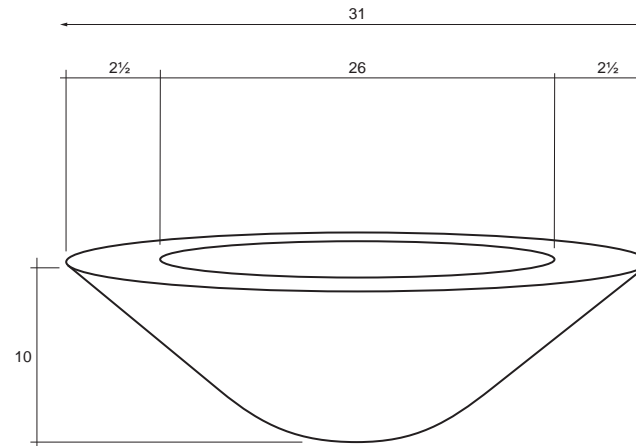

Mounting Plate Included

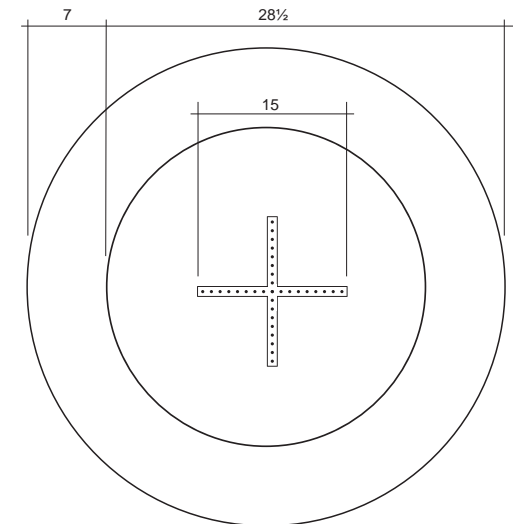



BURNER UNIT ASSEMBLY

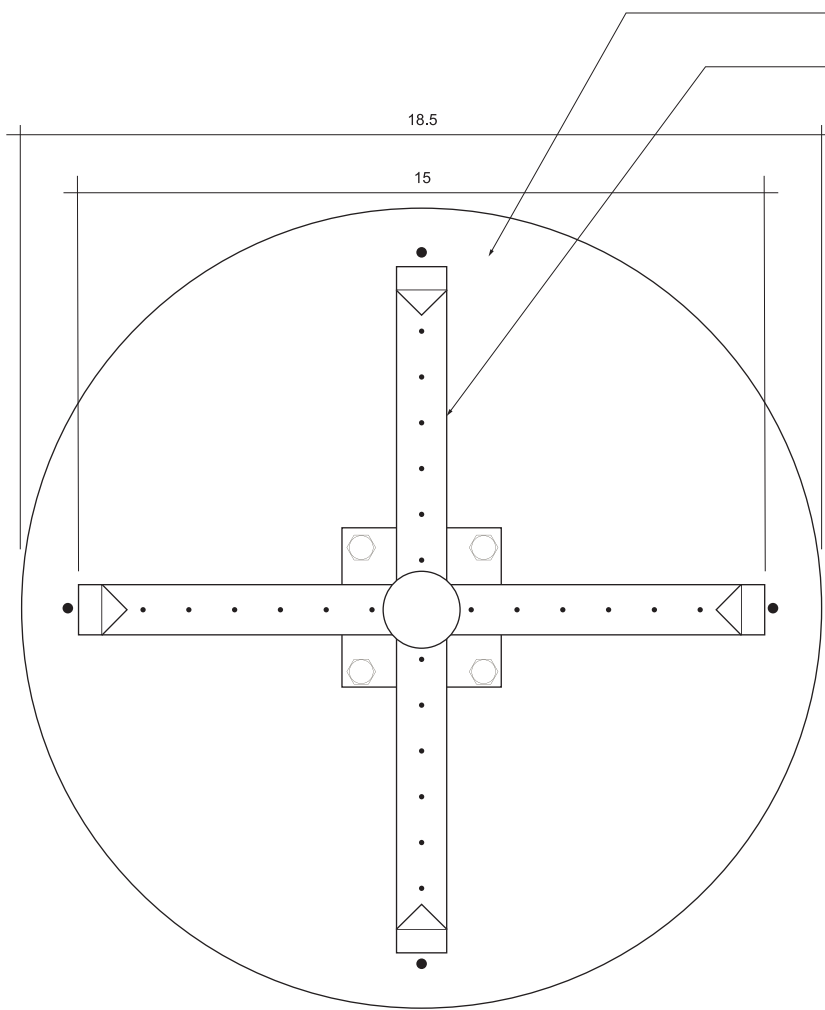

18.5" Stainless Steel
Burner Plate

15" Stainless Steel
Burner Cross

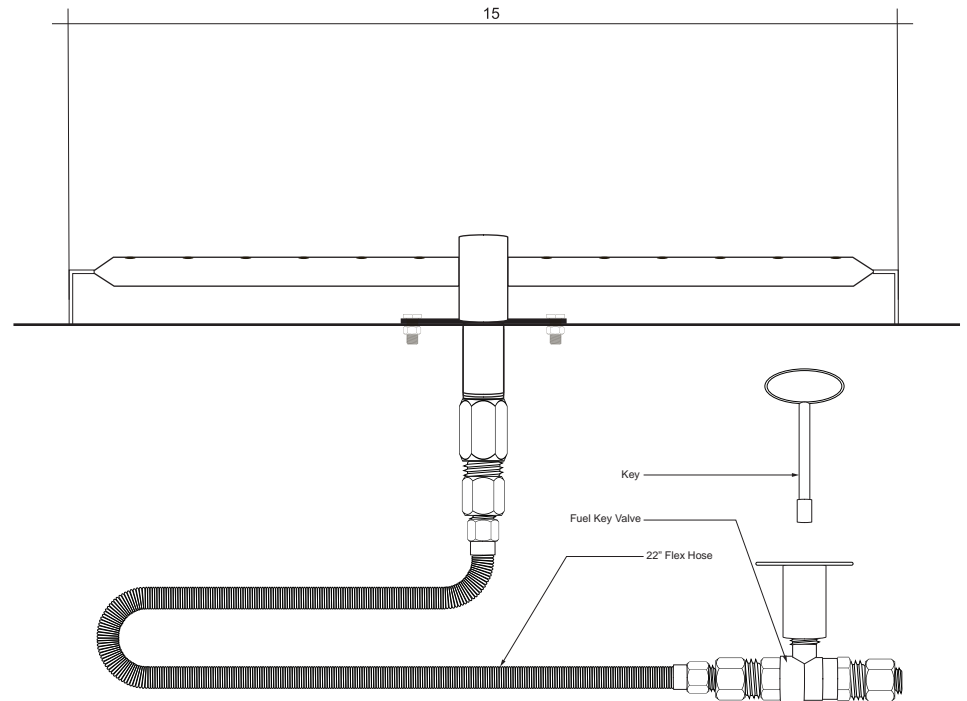

15

Key

Fuel Key Valve

22" Flex Hose

New Cross Burner Specifications

- Made in the USA
- 65,000 BTU's
- Key Valve Ignition
- 304 Stainless Steel
- Tested to meet CSA/ANSI standards
- 2-year Warranty





Falò (Wood Burning)



SPECIFICATIONS

Diameter	21"
Height	10½"
Weight	30 lbs.
Fuel Source	LP or NG
Materials	Glass fiber reinforced cement
Burner Pan	High Temp Powder Coated Steel

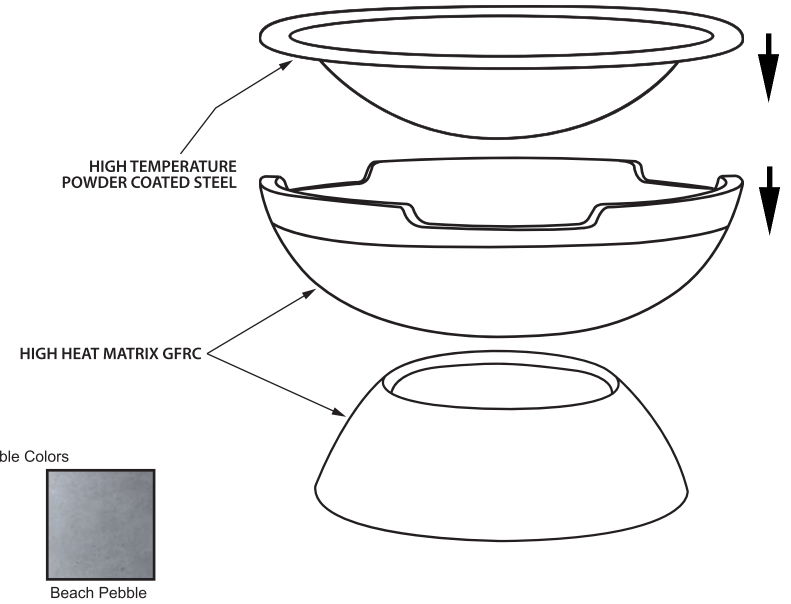
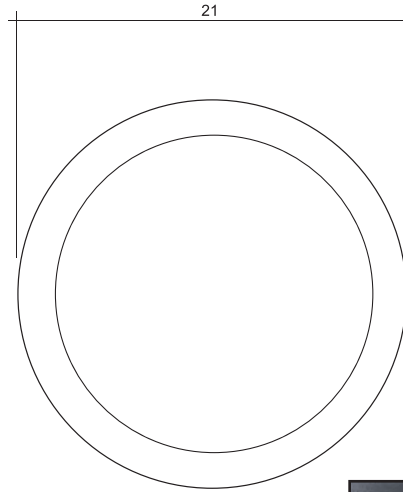

LIGHT WEIGHT



QUICK ASSEMBLY



RUST RESISTANT



FROST RESISTANT



EASY DISPOSAL



HEAT RESISTANT



create the perfect environment

- fire anytime, anywhere.
With Falò's lightweight and portable design, you can create the perfect lighting, warmth and ambiance for an evening with friends & family.
- modern design
Falò uses the perfect blend of design and modern materials to create the lightweight, sleek look of the fire bowl, while maintaining the integrity of the materials under extreme conditions.
- portability
Falò uses state of the art technology to create the perfect accessory for your outdoor setting. Lightweight yet strong, use Falò at your home, or take it with you for an outdoor adventure. Falò's quick assembly allows for easy travel and set up.





Pewter



Natural



Café

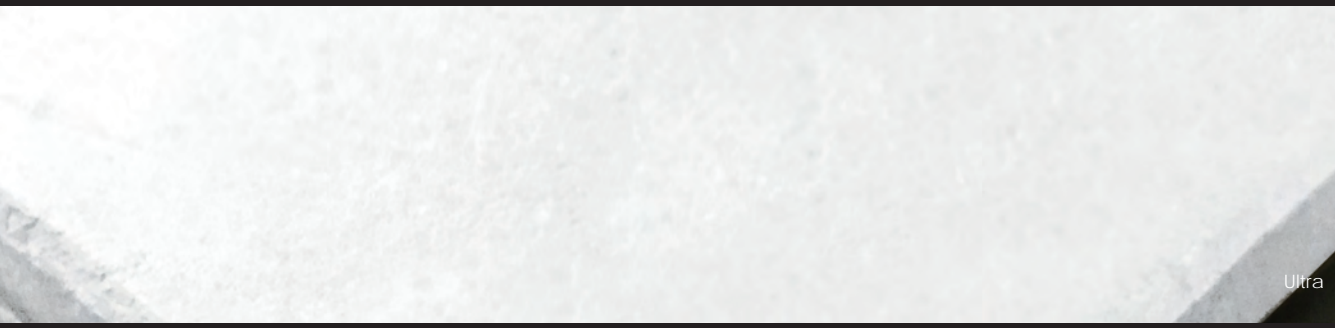

Ultra



Ebony



3/4" Volcanic Rock

We work with you to create custom, visionary designs coupled with handcrafted processes to meet your project needs & requirements.





Prism Hardscapes is dependable, personalized products that capture your outdoor living area ideas down to the last detail.

Before you break ground on a new project, you first need to consider your design preferences. That means learning how to select the perfect colors, shapes and patterns to create an outdoor living space that not only fits your yard, but your lifestyle and vision. Let Prism Hardscapes help get you there.

